

## Electrical Components Inspection (Cont'd)

### FULL COLD SWITCH

Check continuity between terminals with temperature control lever set at full cold position.

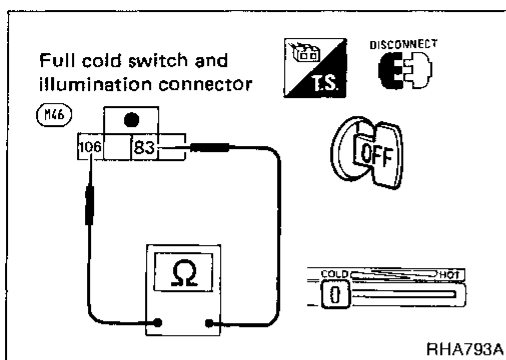

RHA793A

### VENT MODE SWITCH

Check continuity between terminals with mode switch set at VENT mode.

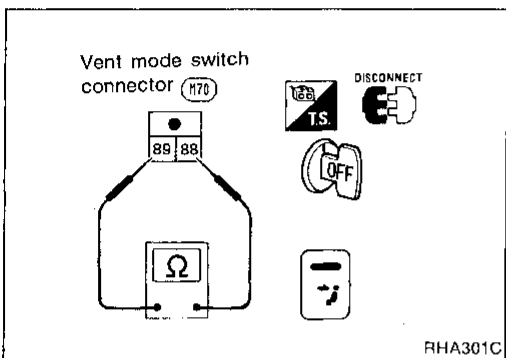

RHA301C

## Control Linkage Adjustment

### MODE DOOR

1. Move side link with hand and hold mode door in VENT mode.
2. Install mode door motor on heater unit and connect it to main harness.
3. Turn ignition switch to ON.
4. Turn VENT switch ON.
5. Attach mode door motor rod to side link rod holder.
6. Turn DEF switch ON. Check that side link operates at the fully-open position. Also turn VENT switch ON to check that side link operates at the fully-open position.

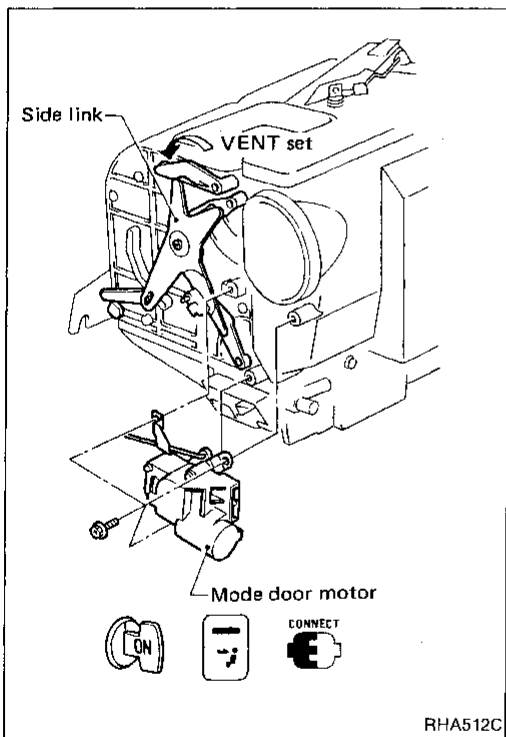

RHA512C

### TEMPERATURE CONTROL CABLE

- Clamp the cable while pushing cable outer and air mix door lever in direction of arrow.

After positioning control cable, check it operates properly.

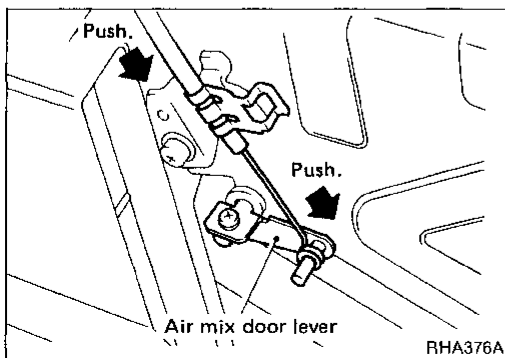

RHA376A