

# Technical Service Information

## NISSAN RL4FO2A AND RE4FO2A SOFT 1-2 UPSHIFT

**COMPLAINT:** Soft and/or a Slide-Bump 1-2 upshift on Nissan vehicles equipped with the RL4FO2A or the RE4FO2A transaxles.

**CAUSE:** The cause may be, too much accumulator piston movement.

**CORRECTION:** Remove and discard the large diameter accumulator spring as shown in Figure 2. Use the illustrations in Figure 1 and 2, to ensure proper reassembly.

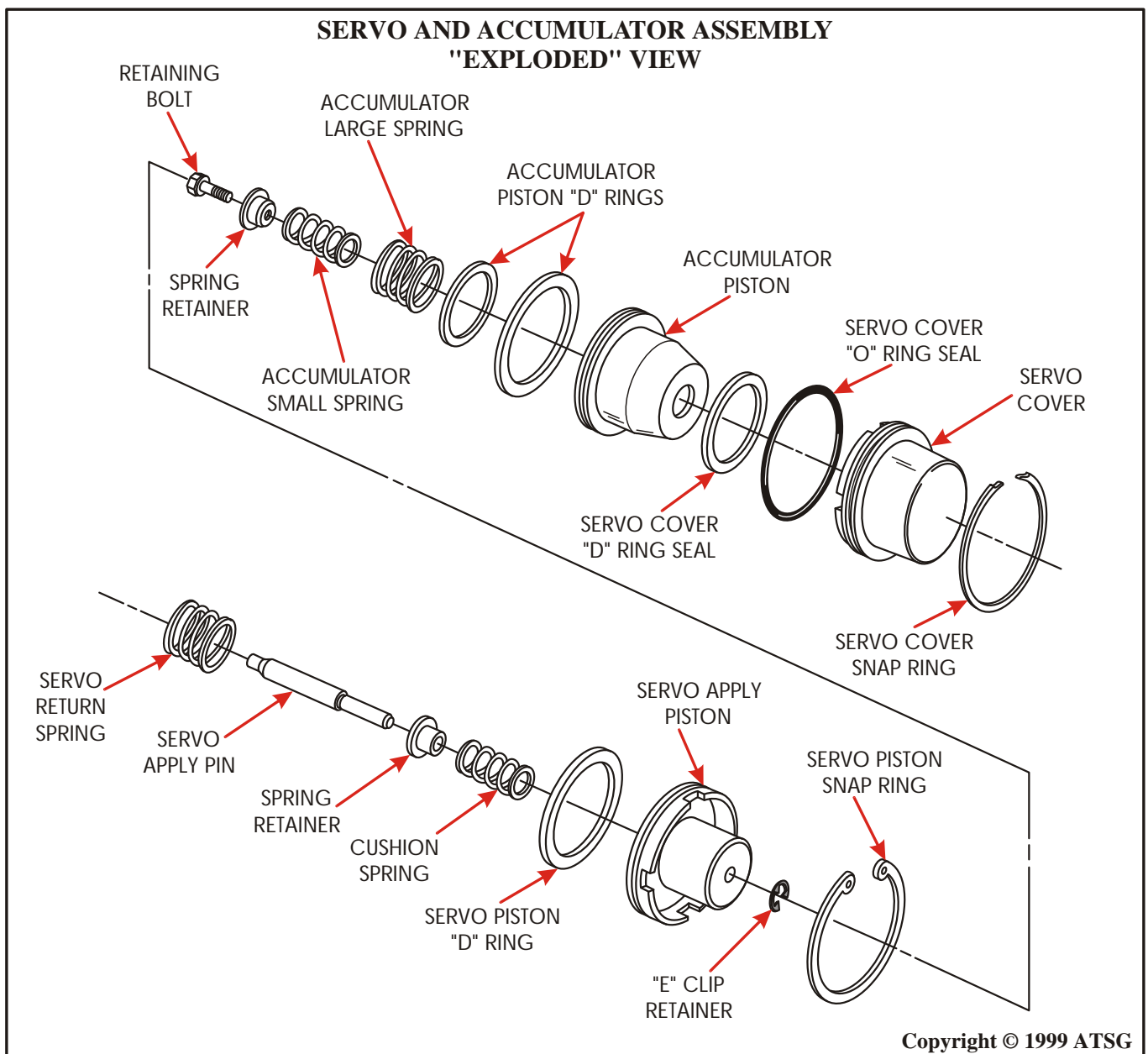

## SERVO AND ACCUMULATOR ASSEMBLY "CUT-AWAY" VIEW

*For a much improved 1-2 upshift,  
remove and discard the large  
accumulator spring.*

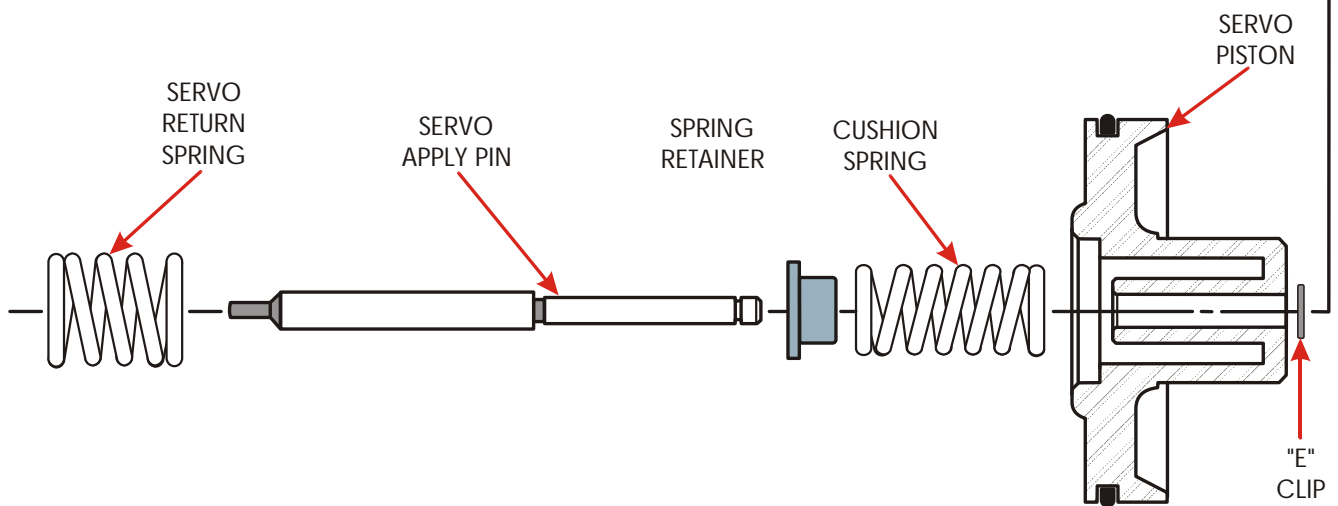
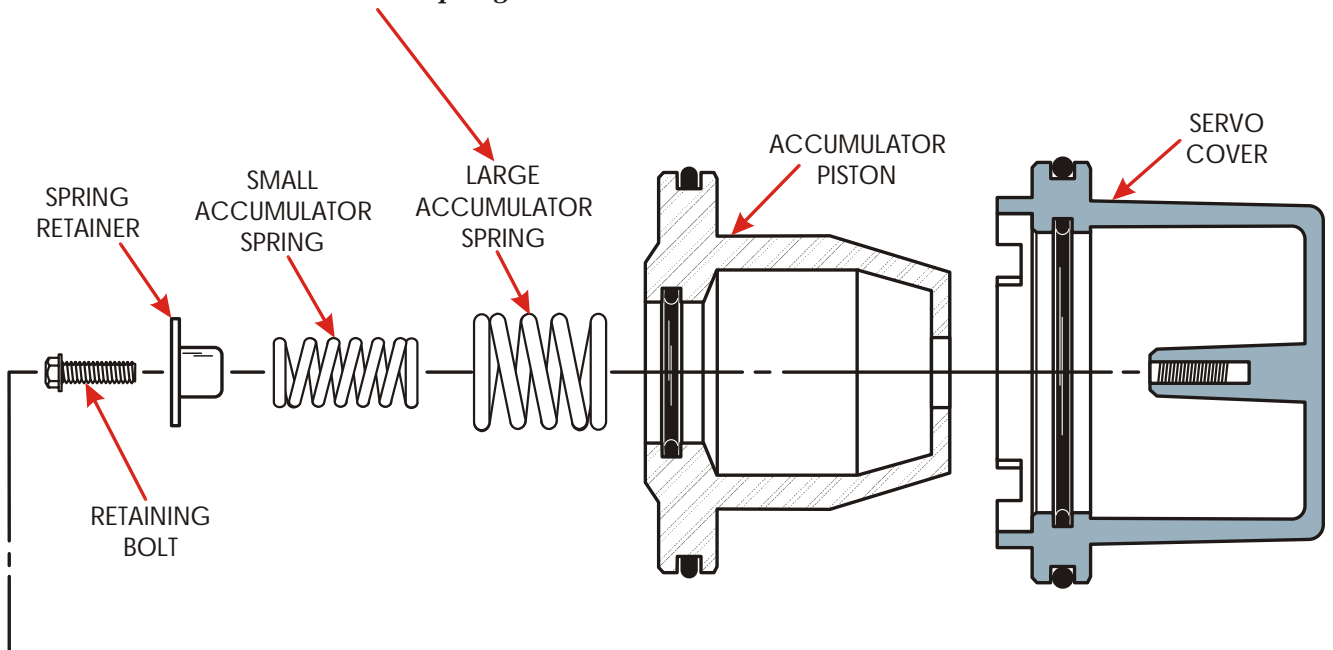

Copyright © 1999 ATSG